

# FRANKLIN MULTI-GEN

## INCREDIBLE INCLUDED FEATURES

- James Hardie Siding
- 9 Foot Ceiling on First & Second Floor
- First Floor Multi-Generational Suite
- Tray Ceiling in 2nd Floor Master
- Large Kitchen Island
- Mudroom off Garage Entry
- Separate Soaker Tub & Shower in 2nd Floor Master

## SELECTED HOME ENHANCEMENTS

- Covered Porch
- Sunroom
- 2nd Floor Laundry
- Fireplace
- Double Oven
- Flex Room/Cased Opening



FARMHOUSE



TRADITIONAL



COASTAL



CRAFTSMAN



## PLANTERS STATION

- PHASE 1
- PHASE 2
- PHASE 3
- PHASE 4
- PHASE 5
- Potential Change to Commercial

### LOCATION



**ETHERIDGE CONSTRUCTION**  
*homes built for your family by ours*  
[EtheridgeConstruction.com](http://EtheridgeConstruction.com)

5859 Harbour View Blvd., Suite 300, Suffolk, VA 23435  
 757-932-7990  
 Sales & Marketing by Rose & Womble Realty Co. | (757) 935-9010

# PLANTERS STATION

Suffolk, Virginia

# The FRANKLIN MULTI-GEN

Plan

FIRST FLOOR



Coastal Elevation Porch

SECOND FLOOR

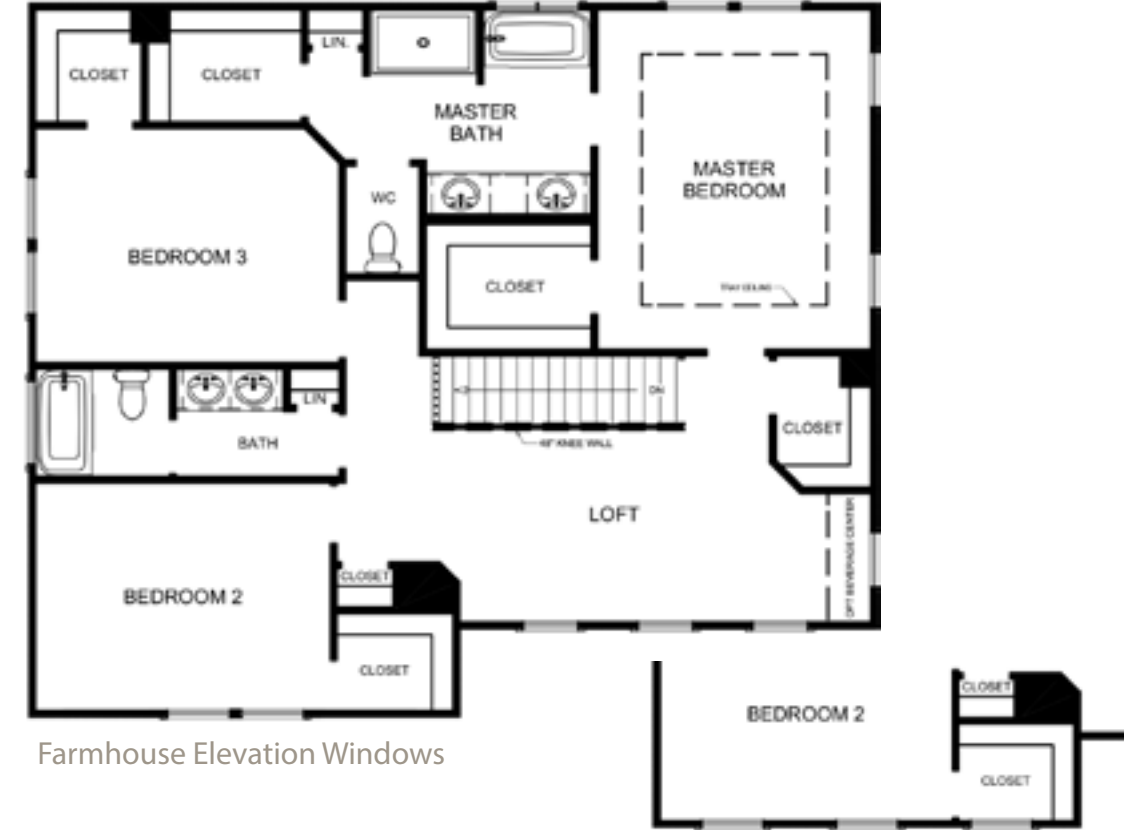

Farmhouse Elevation Windows

Traditional, Coastal & Craftsman Elevation Windows



Optional Second Floor Laundry

